

OWNER'S INSTRUCTION & SAFETY MANUAL



**SPECIALIZED FOR SKORPION XBH
RECURVE CROSSBOW LINE**

Bignamí[®]
dal 1939

Instruction manual for SKORPION XBH crossbow



* The arrow shown on the track is only for demonstration
package include 2 arrows.

IMPORTANT! Be sure to Read this Instruction sheet given before using this product carefully AND Follow the indications. Keep instructions and safety manual for future reference.

INTRODUCTION

Thank you for choosing a product of the SKORPION Crossbow Line. We are confident that you will enjoy the crossbow for many seasons to come. Congratulations on your purchase, enjoy yourself, and thank you once again!

COMPONENT GUIDE



SETTING UP YOUR CROSSBOW

ADJUSTABLE REAR STOCK INSTALLATION

1. Remove the lock screws from the side of adjustable butt plate.
2. Slide the butt plate onto the stock rod and adjust your desired position and make sure the screw holes are lined up with the stock accordingly.
3. Tighten the lock screws with the nuts from side of the adjustable butt plate, please make sure your butt plate is firmly attached to the stock. (Do not over tighten).

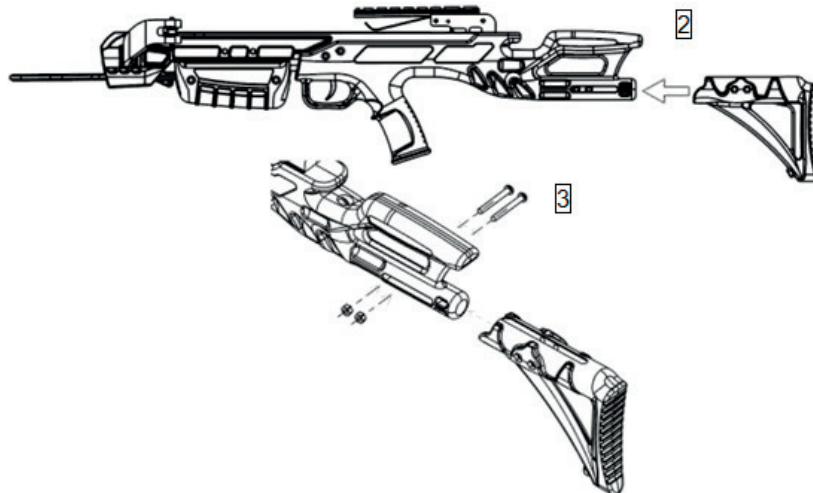

LIMB MODULE INSTALLATION

1. Insert the limb module into the gap at bottom front of the barrel making sure the bowstring is positioned above the flight rail as shown. Use a tape measure to center the limb in the barrel, this is critical for accurate shooting.
2. Position the limb cap on the bottom of the barrel. (As shown by the arrows on the illustration)
3. Tighten the lock screws from the bottom and make sure the cap and barrel are firmly attached to each other.
4. Tighten the nose bolt from front of the riser firmly.

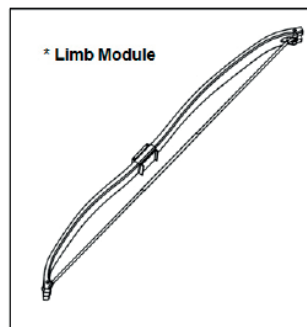
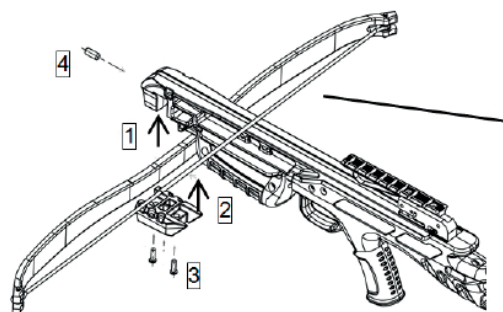

INSTALL YOUR STIRRUP

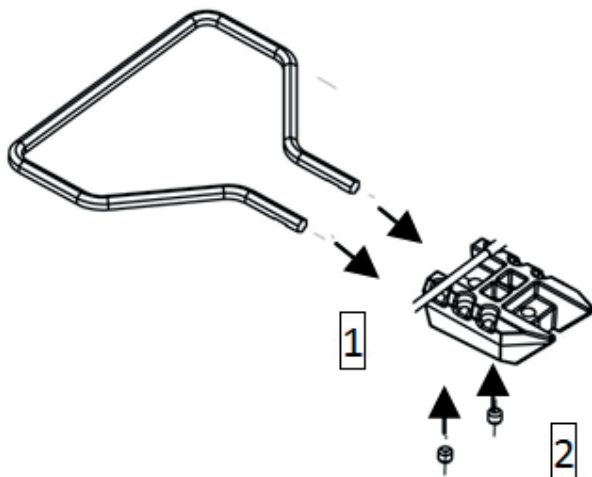

1. Insert the foot stirrup into the two holes on the front of the bottom limb cap (illustration below shows the limb cap component only - which you have already attached to the stock during the limb module assembly). Make sure the 2 notches in the foot stirrup are facing downward towards the grub screws used to secure the stirrup.
2. Tighten the 2 set screw for the stirrup from the bottom and make sure they are firmly tight.

WARNING! Serious injury or damage may occur to you and your crossbow if you do not tighten the screws securely)

QUIVER SET UP

BOOSTER QUICK RELEASE MOUNT QUIVER INSTALLATION.

1. Tighten the mounting screws until the quick release mounting bracket is securely attached on your crossbow (it will be placed on the bottom of the limb cap - just behind the foot stirrup) Do not over tighten, but make sure it is firmly attached.
2. Slide the Quiver into the groove on the quick release mounting bracket. Make sure the locking lever is in the open position.
3. Lock the quiver by turning the locking handle, you can unlock and remove the quiver by opening the locking handle.

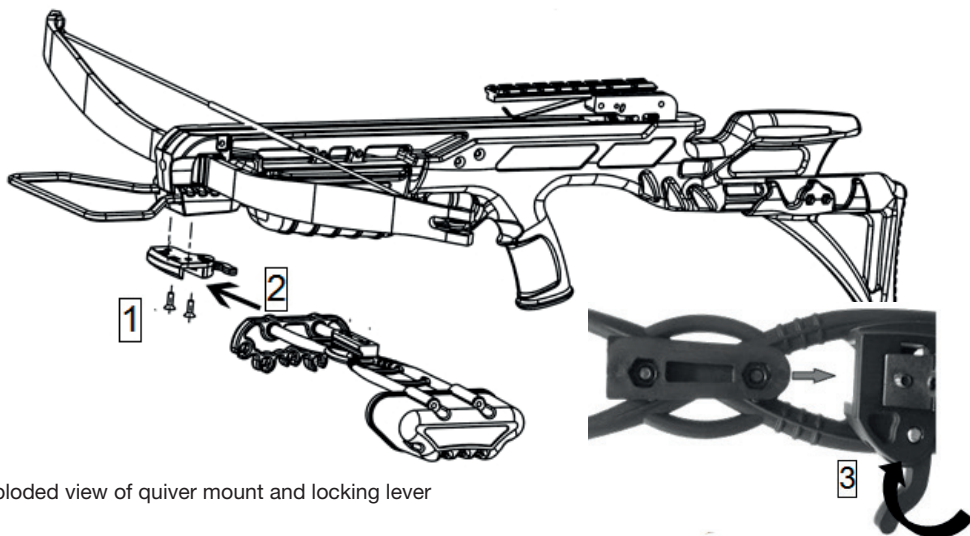

Exploded view of quiver mount and locking lever

USING YOUR CROSSBOW SCOPE



Your crossbow package comes standard with a 4x32 multiple reticle scope that is designed to offer you multiple yardage options without having to adjust. Start by sighting in your crossbow at the closest yardage you plan to hunt from. A reasonable yardage to get started might be 10 m for the top line on the crosshairs. Once you have zeroed in on the closest range, you will need to progressively move back in yardage in order to determine the remaining yardage points that your scope will be sighted. Because the lines all move together your closest sight point will be the one you are adjusting using the windage and elevation knobs on the scope.

NOTE: SCOPE RETICLE & ADJUSTMENT DIAL DESIGNS MAY VARY FROM THOSE SHOWN.

TACTICAL GRIP ADJUSTMENT



NOTE: THIS APPLIES TO TACTICAL MODEL ONLY - HOWEVER, THIS IS AN OPTIONAL ACCESSORY AVAILABLE FOR PURCHASE.

1. Untighten the side set screw on the tactical grip.
2. Attached your tactical grip onto your desire position on the picatinny rail.
3. Tighten the set screw and make sure it's firmly tight (Do not over tighten)

COCKING YOUR CROSSBOW

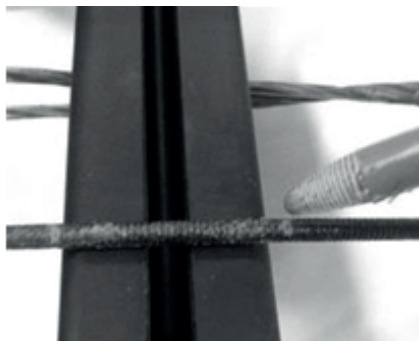

Before you begin to cock your crossbow, re-measure the limb to be sure it is perfectly centered then mark your string for center while the bow is un-cocked (this will allow you to quickly check that your limb is always centered and has not shifted). It is extremely important that you cock the crossbow centered each time and in the same manner to get the most accuracy possible out of the crossbow, this will be especially important if you choose to cock the bow by hand (not recommended) and not utilize the rope cocker. For the most consistent accuracy possible when manually cocking the crossbow mark the string on both sides of the flight rail so that you can verify it is cocked straight each shot. It is easy to cock the bow off center when manually pulling it back. Your best option is to use the rope cocking device each time you shoot for the most consistent shooting possible.

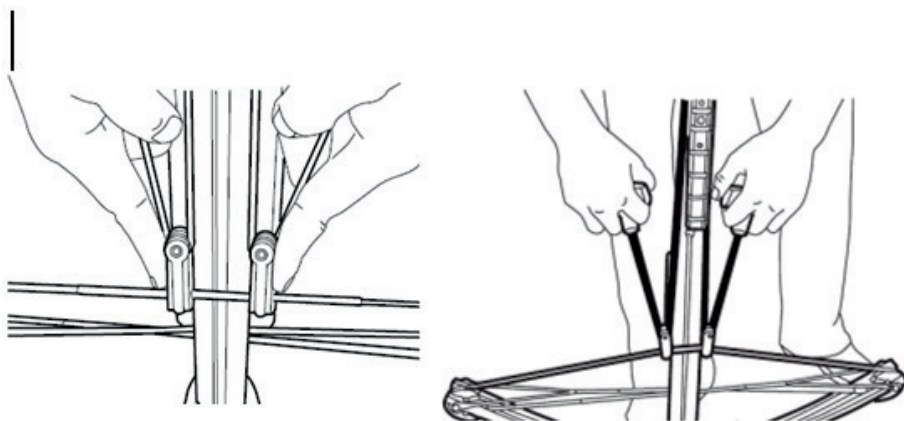
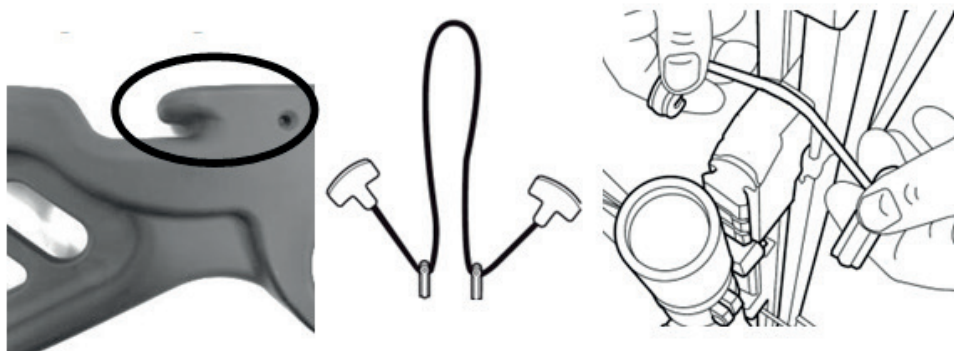
HOW TO USE THE ROPE COCKER

Use of the rope cocker reduces the effort required to cock your crossbow by 50%. This device also ensures perfectly straight cocking, a key ingredient of top accuracy. Make sure the trigger safety is on the "Fire" position while your crossbow is facing toward ground for the cocking procedure below:

1. Place one foot securely through the foot stirrup.
2. Place the center of the cocking rope in the rope groove behind trigger box. The cocking handles should be positioned to the outside.
3. Pull both cocking hooks simultaneously down along the flight rail and attach them to the bowstring directly alongside the rail.
4. Pull both handles evenly toward you until you hear a click and you feel the string is securely engaged.

TIP: For maximum accuracy hooks must stay against the flight rail during cocking operation - DO NOT LEAVE A GAP.

FIRING YOUR CROSSBOW

- Once the bow is cocked the safety will automatically be in the “S (Safe)” position. Load an arrow and make sure the arrow retainer spring has just enough pressure to keep the arrow fully loaded, positioned all the way against the string inside the trigger mechanism. (If the arrow is not fully seated against the string a DRY FIRE will occur and damage/possible injury may result)
- The safety is on the “S (Safe)” position. Once you are aiming at your target, push the safety forward to the “F (Fire)” position.
- The crossbow is ready to fire when the trigger is pulled. Once the crossbow is fired, simply re-cock the bow and the safety will automatically be in the “S (Safe)” position. Do not attempt to reposition the safety prior to cocking the bow or the unit will not cock properly.

IMPORTANT: MAKE SURE TO KEEP YOUR FINGERS AND THUMB BELOW THE TRACK SURFACE DURING FIRING AT ALL TIME.

INCORRECT FINGER POSITION**CORRECT FINGER POSITION**

DRY FIRING (FIRING WITHOUT ARROW) WILL VOID THE WARRANTY FOR ALL PARTS!

IMPORTANT: GENERAL SAFETY GUIDELINE

EXTREME CAUTION SHOULD BE USED AT ALL TIMES WHEN HANDLING A CROSSBOW. FAILURE TO FOLLOW THESE INSTRUCTIONS COULD RESULT IN SERIOUS INJURY OR DEATH.

- Always keep your fingers below the flight track and out of the path of cables and strings when firing the crossbow.
- Never dry-fire the crossbow (shooting without an arrow or too light of an arrow, or arrow not seated properly). Dry firing will void the warranty and can result in damage to the limb assembly and possibly cause personal injury.
- Never fire the crossbow until you are sure of your target.
- Always use an adequate target and backstop when target shooting.
- Always use suitable crossbow arrows with half-moon nocks.
- Always inspect the crossbow and arrows before firing. Bent or damaged arrows are not safe to fire and should be discarded.

Translation by Bignami S.p.A.

The data listed in this manual have been given by the producer and may be subject to change anytime without prior notice.

Bignami S.p.A. is not to be held responsible for any inaccuracy and/or any possible typographic error.



Bignami[®]
dal 1939

Bignami Spa
Via Lahn,1 - 39040 Ora (BZ)
Tel. 0471 803000
www.Bignami.it